

ALEXANDRIA, VA



Upland Park is a 9-acre site with a two-phase development project in the heart of Alexandria, VA. The first Phase will include townhouse lots delivered to the home-builder. The project will continue thereafter with construction of a Multi-family building with ground-level retail, followed by the construction of a 171-key hotel.

This project is located approximately 5 minutes by car to the new Amazon HQ2 and the new VA Tech Innovation campus. The property will also benefit from a new Bus Rapid Transit (BRT) line that will connect the site to the pentagon as well and the Metro, HQ2 and VA Tech campus.

Project Details:

- 401 Multifamily Apartments
- 92 Townhouse Units
- 171-key Hotel
- 8,470 SF ground level retail

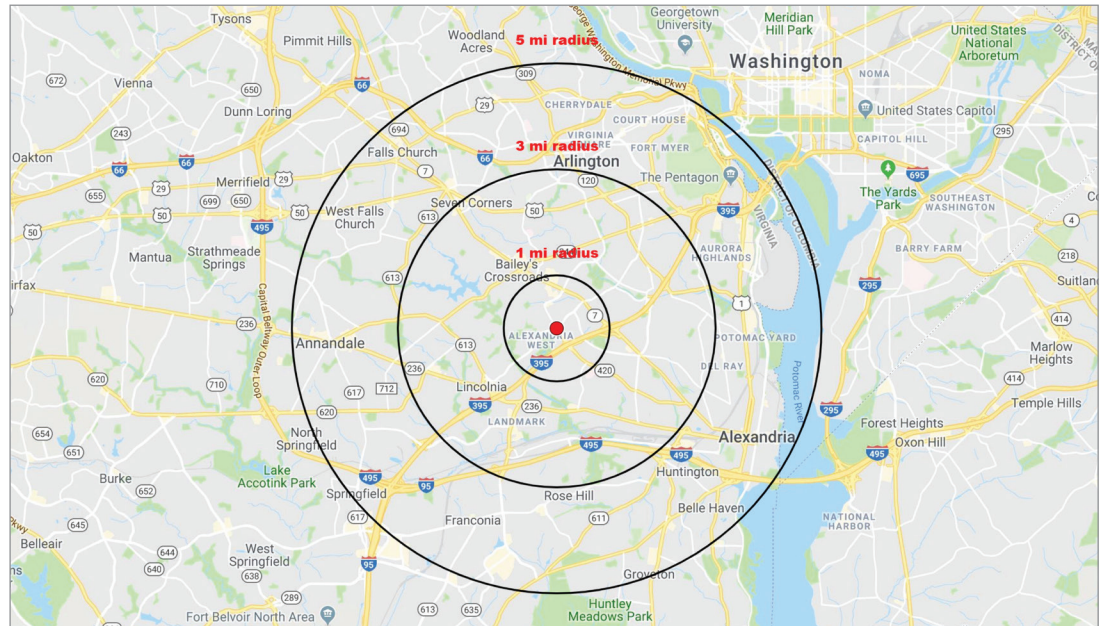

DEMOGRAPHICS

POPULATION

1 MI.

48,879

3 MI.

253,524

5 MI.

610,538

AVG. HOUSEHOLD INCOME

\$102,926

\$120,730

\$139,102



hekemian.com

505 Main Street / Hackensack, NJ / 07602 / 201.487.1500

Alexandria, VA



UPLAND PARK | PHASE I SITE PLAN

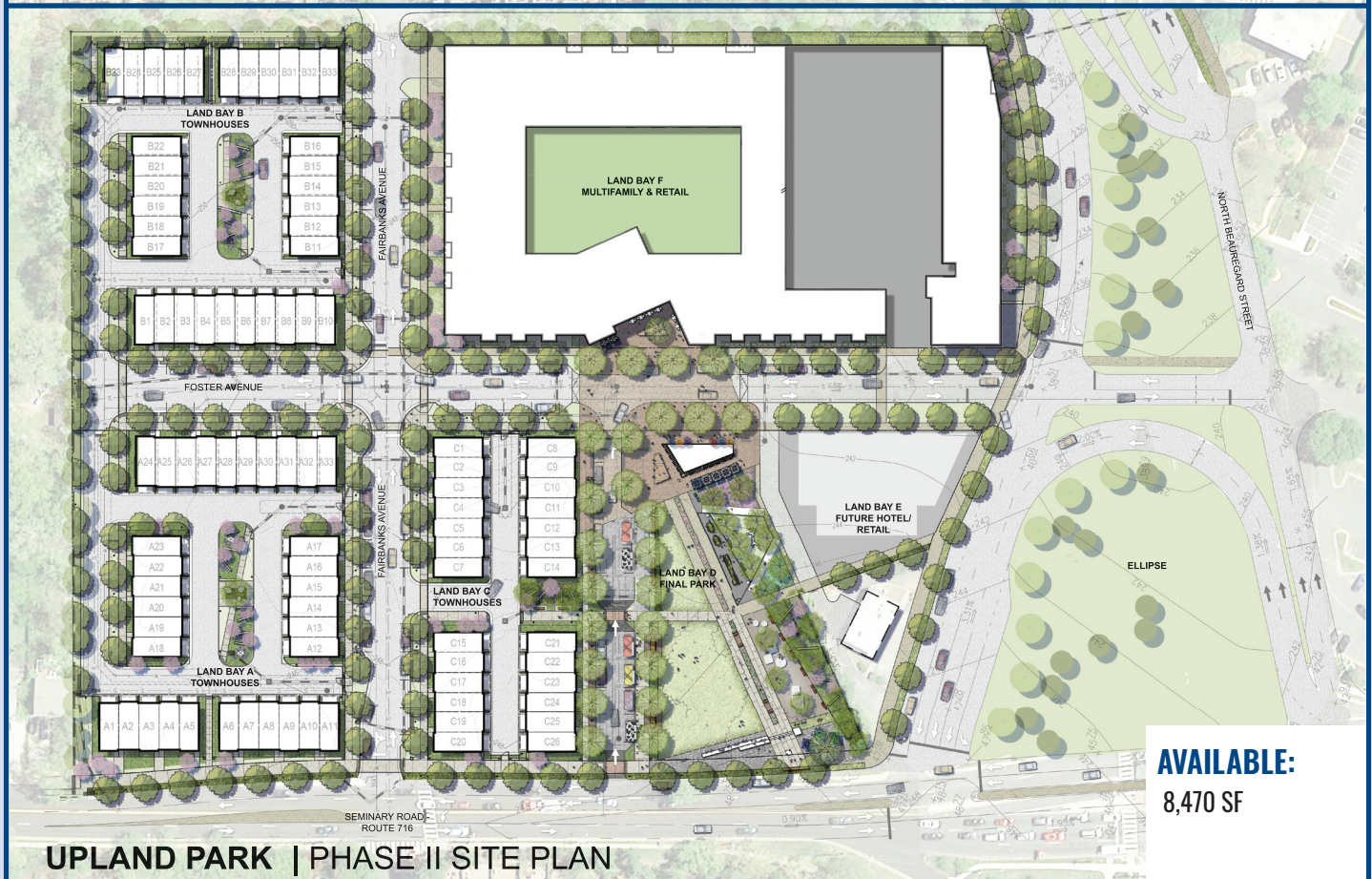

UPLAND PARK | PHASE II SITE PLAN

AVAILABLE:
8,470 SF